

100V-240V AC



Approval Marks



Electronic

Parameter	Conditions	Min	Nom	Max	Unit
I/P Voltage Range		90	230	264	Vac
Input Frequency		47	50-60	63	Hz
Output Power(Pout)	Regular LED	-	1-10	-	W
Input Current(Iin)	25°C, Nominal Input@120VAC	-	-	200	mA
Output Voltage(Vout)		11.88	12	12.12	Vdc
Output Current(Iout)	25°C, Nominal Input	40	-	830	mA
Protection	Overload Protection				
	Short Circuit Protection(Auto-Restart)				
	Over Heat Protection				
Ambient Temp.		-20	-	+50	°C
Case Temp. (Tc)	Normal Conditions	-	-	+75	°C

Lamp Type Regular LED 0.04~0.1W

Application Space

Indoor Use
(Low Humidity, No Condensation)

Physical

Parameter

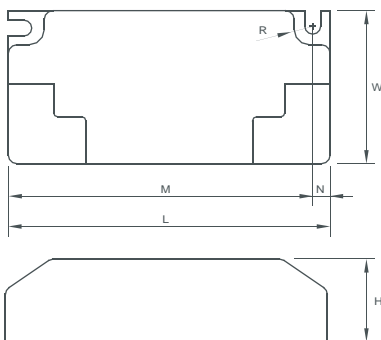

L : 85 mm H : 22 mm
 M : 76.2 mm K : mm
 N : 4.6 mm R : 2.1 mm
 W : 40.4 mm Slot On One Side Allowing Alignment : M+/-3 mm

Tolerance : $\geq 0 \sim 100 \geq +/0.5\text{mm}$
 $100 \geq +/1 \text{ mm}$

- Terminal Block : Screw Type Terminal
- Housing Material : Polycarbonate
- Soldering : Lead-Free, Comply With RoHS
- Label : Surface Print

Wiring Diagram

